



**AURA**<sup>TM</sup>  
PERFORMANCE HEATERS

# SHADOW

---

S E R I E S

NO-LIGHT  
RADIANT HEATER







# SHADOW | SERIES

DS24240B – Black  
up to 2400W

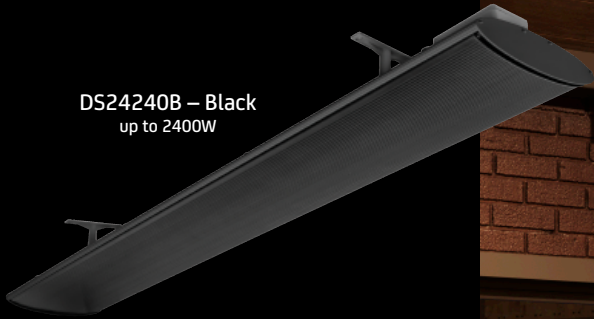

DS32240B – Black  
up to 3200W

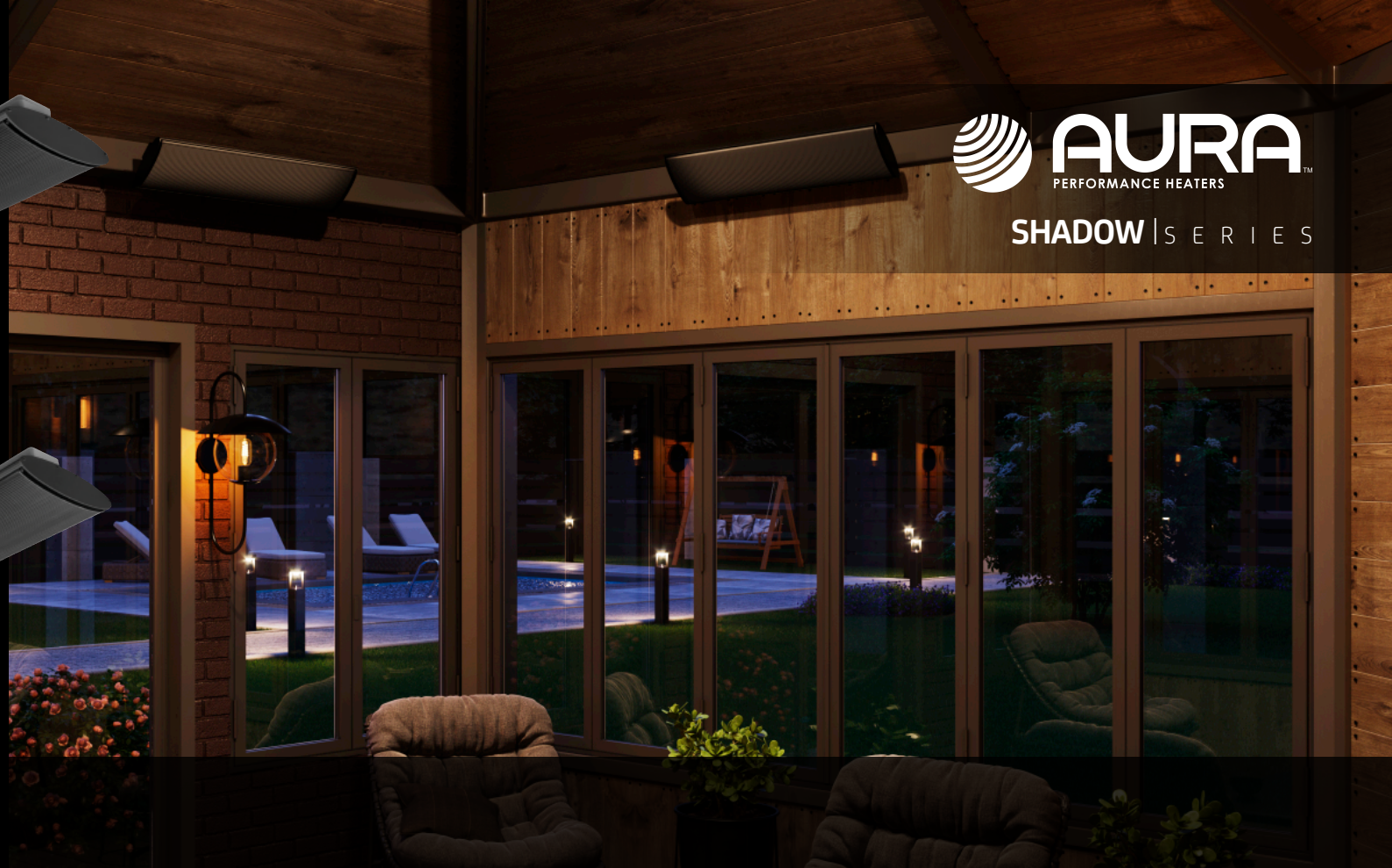

Aura Shadow	Power	Voltage	Current	BTU	Min Mount Height	Ceiling Clearance		Sidewall Clearance	Certification
						Bracket Direct	Wall Mounted		
DS32240B Black	3200/2400W	240/208V	13.3/11.5A	10,920/ 8,190 btu	79 inch (2100 cm) US 96 inch (2400 cm) CDN	4 inch (10 cm)	8 inch (20 cm)	36 inch (100 cm)	cETLus (UL2021/CSA22.2)
DS24240B Black	2400/1800W	240/208V	10/8.7A	8,200/6,200 btu	79 inch (2100 cm) US 96 inch (2400 cm) CDN	4 inch (10 cm)	8 inch (20 cm)	36 inch (100 cm)	cETLus (UL2021/CSA22.2)
DS15120B Black	1500W	120V	12.5A	5100 btu	79 inch (2100 cm) US 96 inch (2400 cm) CDN	4 inch (10 cm)	8 inch (20 cm)	36 inch (100 cm)	cETLus (UL2021/CSA22.2)

NO LIGHT RADIANT HEATER FOR USE IN ENCLOSED OR SEMI-ENCLOSED OUTDOOR SPACES IN MODERATE CLIMATES. INSTALLER, SPECIFIER OR ENGINEER SHOULD TARGET 8' MOUNTING HEIGHT TO BOTTOM OF HEATER FOR OPTIMAL PERFORMANCE.